

valco
baby

ASTRO

FOLDING HIGHCHAIR

PRODUCT REFERENCE GUIDE

Thank you for purchasing a quality VALCO product. Please read and follow the instructions outlined in this guide carefully. Familiarise yourself with the construction and safety features; be sure that you understand all the warnings and safety guidelines before use.

Important: Please read the following instructions carefully before assembling this product. Retain this guide in a safe place for future reference.



Due to our policy of continuous product development, this product is constantly evolving. It is possible that some features or procedures outlined here have changed since this document was written. If you are unsure of any procedure shown here, please contact us via the web at info@valco.com.au to obtain the most up to date information before use. Include the batch number, which can be found on a sticker on the frame.

All pictures and diagrams herein are provided for illustration purposes only. Actual product, colour or fabric may vary. VALCO reserves the right to modify or alter any specification or colour without notice or obligation to modify any product previously purchased

FURTHER INFORMATION

In Australia/New Zealand

www.valco.com.au
www.valco.co.nz

In North America only

www.valcobaby.com
USA: 1800 610 7850
CANADA: 416 488 1900

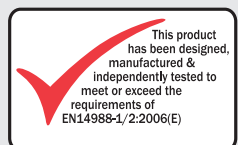

© Copyright VE 2008

HIGH CHAIR ASSEMBLY/OPENING

CONTENTS

FIGURE A

1. Your Astro High Chair arrives flat packed and complete. It requires no frame assembly. Remove all parts of the High Chair from the carton and packaging. Dispose of any packaging thoughtfully and responsibly.

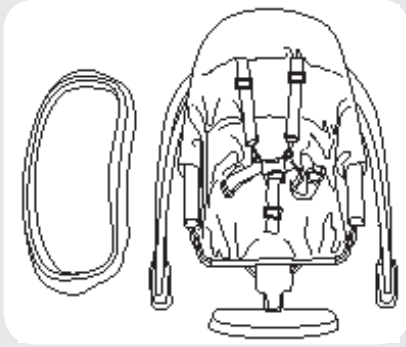

OPENING THE HIGH CHAIR

FIGURE B

2. Place your Astro High Chair flat on the floor.
3. Grasp the the center back of the seat. Using an upward motion, raise the Astro High Chair until it 'click's into place.

NOTE: YOU MAY NEED TO PLACE YOUR FOOT ON THE LOWER FRAME TO HOLD THE UNIT IN POSITION WHILE LIFTING.

4. Lower the footrest into position by pushing it down until it locks into place.

IMPORTANT WARNING: ALWAYS TEST THAT ALL LATCHES ARE SECURELY ENGAGED BEFORE USE.

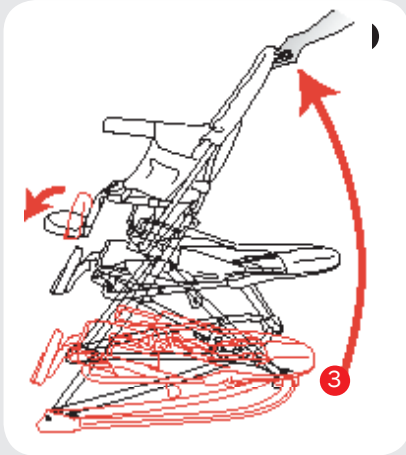

FOOD TRAY

FIGURE C - The Food Tray on your Astro High Chair has three adjustment positions and can be removed for easy cleaning.

CLEAN THE FOOD TRAY WITH WARM WATER AND MILD DETERGENT. DO NOT PLACE IN THE DISHWASHER.

5. To attach or remove the Food Tray, locate the release levers found on the underside on each side of the tray.

FIGURE D

6. While squeezing the release levers simultaneously, slide the tray into position over the side seat armrests. Release the levers and move the tray slightly forward or backward until it locks into the next position.

7. Use the release levers to adjust the tray position, or to remove the tray unit.

WARNING: DO NOT FORCE TRAY INTO CHILD WHEN ADJUSTING THE TRAY. ALWAYS ALLOW SUFFICIENT BREATHING SPACE FOR YOUR CHILDS' COMFORT.

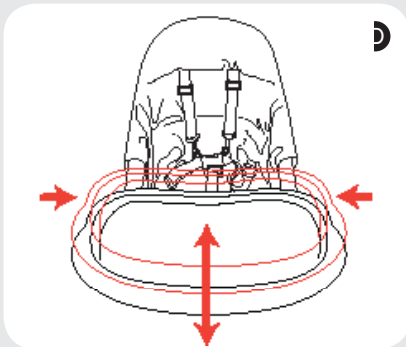
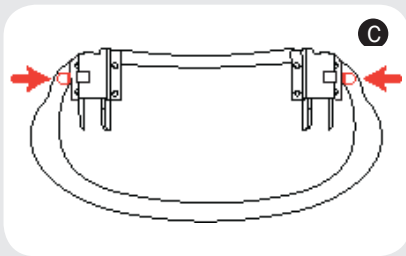

SAFETY HARNESS

Your High Chair is fitted with a 5 point safety harness system. Your child **MUST** always be harnessed while in the high chair.

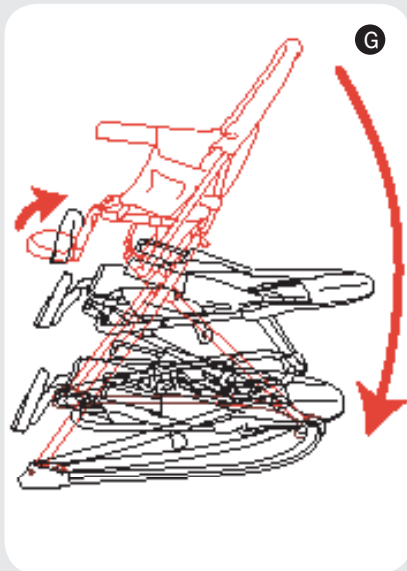
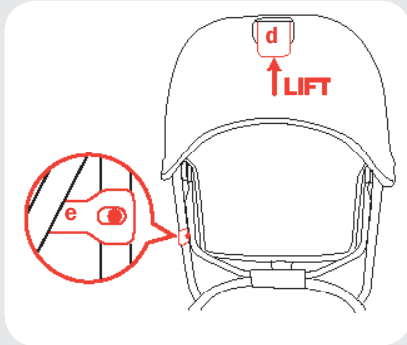
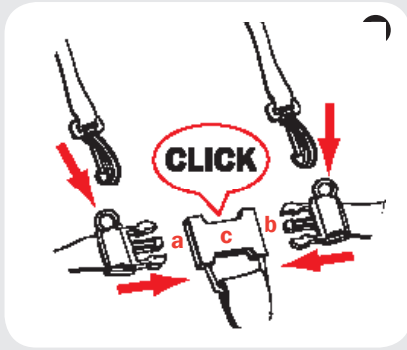

FIGURE E: USING YOUR HARNESS

TO SECURE YOUR CHILD IN THE HARNESS:

8. Insert Buckles (a) and (b) into either side of the Buckle Housing (c). Keep inserting until they click into place securely.
9. Carefully adjust the harness straps to snugly fit your child by adjusting the Sliders located on all Shoulder Straps, Waist Straps and Crotch Strap. The harness should be snugly fitted to the baby's body, tight enough so that the baby cannot wriggle itself free of the straps but loose enough so as not to cause the baby any discomfort.

TO OPEN THE HARNESS:

10. Release the Buckle Prongs – Squeeze on the top and bottom prongs simultaneously and pull apart from the Buckle Housing.

THIS PROCESS MAY BE DIFFICULT AS YOUR BUCKLE SYSTEM HAS BEEN DESIGNED TO MEET VERY STRINGENT SAFETY STANDARDS TO ENSURE THAT A CHILD CANNOT RELEASE THE HARNESS UNAIDED.

CLOSING THE HIGH CHAIR

FIGURE F

11. Locate the release latch on the back of the seat (d) and the frame lock (e) on the side of the seat frame.

FIGURE G

12. Push the footrest into the upright position and remove the food tray (if desired - your High Chair can be folded with the food tray in position).
13. Lift the release lock and simultaneously disengage the frame lock by pulling the plastic tab free of the locking pin.
14. Gently ease the seat down until it has fully collapsed into the closed position.

NOTE: YOU MAY NEED TO PLACE YOUR FOOT ON THE LOWER FRAME TO HOLD THE UNIT IN POSITION WHILE LOWERING.

WARNINGS

REMEMBER... your child's safety is your responsibility...

- Be sure to check that all clamps, Velcro and buckles are securely fixed and in place before use.
- Check all parts for breakage or fatigue before use. Discontinue immediately if any part is found to be damaged or broken.
- DO NOT place your High Chair anywhere near hazards such as open fires or other significant sources of heat such as radiators, barbecues, stoves, etc.
- DO NOT place your child near hazards such as medication, small items that may pose a choking risk, trailing chords or electrical leads, etc.
- NEVER leave your child unattended, even for a short time. ALWAYS keep your child in sight whilst in the High Chair.
- ⚠ WARNING: Prevent serious injury or death from falls or sliding out.
- ⚠ WARNING: The child should be secured in the high chair at all times by the restraining system. The tray is not designed to hold the child in the chair. It is recommended that the high chair be used only by children capable of sitting upright and unassisted.
- ONLY use on a flat, stable surface.
- The High Chair is only to be used with a child that is able to sit in an upright position.
- DO NOT not force tray into child when adjusting the tray, always allow sufficient breathing space for your child's comfort.
- DO NOT allow your child to stand up in the High Chair
- The maximum weight of a child for which this High Chair was intended is 20 kgs (45 lb).
- DO NOT move the High Chair with your child inside.
- When in the High Chair, your child must always wear the safety harness, correctly fitted and adjusted, at all times.
- This product is intended for domestic use only. It is not intended for commercial use.

CARE & MAINTENANCE

- Continued and extended exposure to sunlight and the elements can change the colours of many materials. To avoid fading, always cover and store in a shaded area.
- DO NOT use any bleach based products to clean the High Chair.
- The High Chair can be cleaned using a damp sponge and mild detergent.
- To prevent mould or mildew always allow fabrics to dry COMPLETELY before storing.
- Always store in a well ventilated area.



In Australia/New Zealand

www.valco.com.au
www.valco.co.nz

In North America only

www.valcobaby.com
USA: 1 800 610 7850
CANADA: 416 488 1900